

Order and Quote Form

AR, TR, MND, PPS, PAS, PS & TI Grate Only**Select Grate Style**

TR
Standard
3mm wire
5mm gap

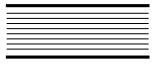

AR
Architectural
2mm wire
2mm gap



PAS
Punched
Angle Slot

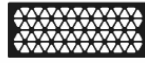

MND
Marc Newson



PS
Punched Slot



PPS
Punched
Perpendicular
Slot



TI
Tile Insert

Grate Dimensions

TR, AR, PAS, MND, PS, PPS Grate Styles

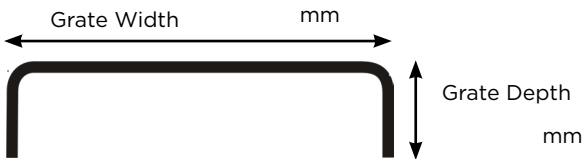

*MND Grate maximum 100mm wide, maximum 90mm deep.

*PPS, PS & PAS over 100mm wide will need to be double punched, please refer to pages 2 & 3

Ti Grate Style

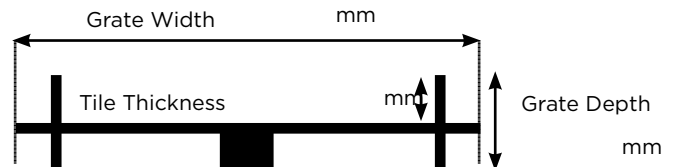
**Specify Length**

mm	
<div style="border: 1px solid black; height: 40px; width: 100%;"></div>	Grate 1
mm	
<div style="border: 1px solid black; height: 40px; width: 100%;"></div>	Grate 2
mm	
<div style="border: 1px solid black; height: 40px; width: 100%;"></div>	Grate 3

Full Name

Email Address

Company Name

Order Number

Stormtech Quote Number

Telephone

Signature

PPS/ PAS Grates Over 103mm wide

Please note that any of our grates over 103mm wide (110mm wide o/a with channel included) will look slightly different to advertised.

See below 2 options that you have when ordering one of these grate styles over 103mm wide.

Double Punched



With this option, the slots will still reach towards the edge of the grate, however having to punch this grate twice to achieve this width will leave the notches as per the above highlighted red image.

Standard Width Slots

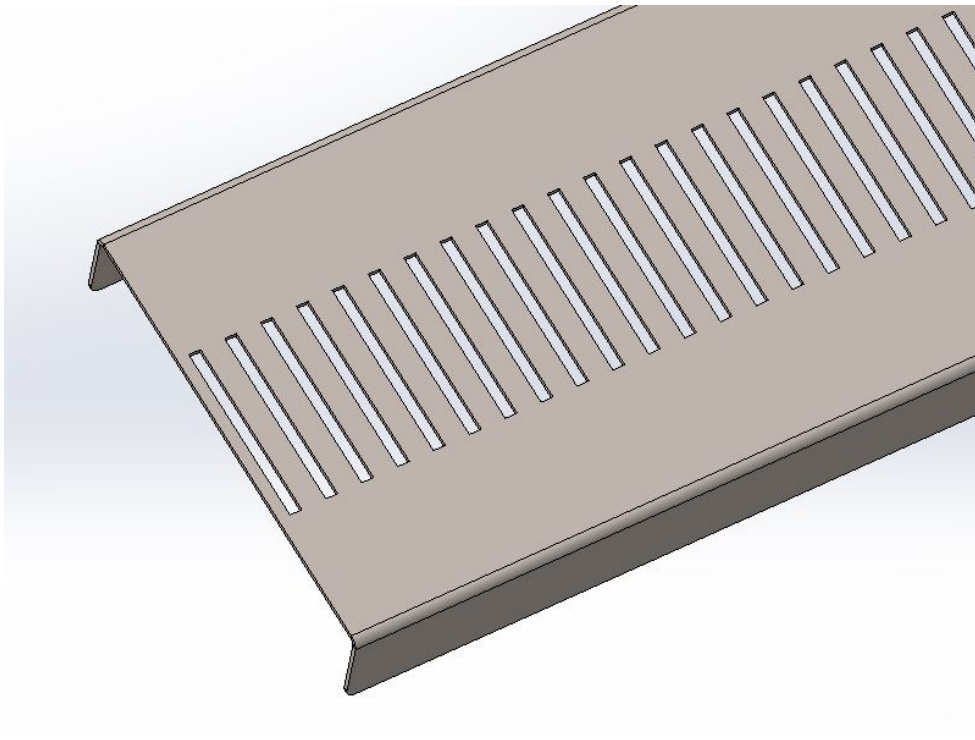

With this option, the slots will not reach the edge of the grate and would leave excess space on each side of the grate as per the above image. This specific image shows how much space would be left on a 200mm wide grate.

[Please contact our customer service team to advise which option you would like to proceed with.](#)